

**A-A(2:1)**

**B-B(2:1)**

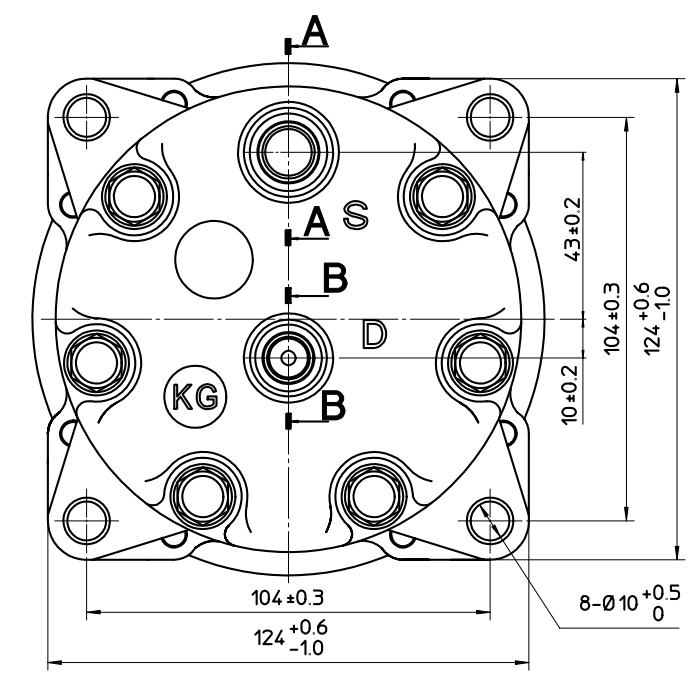
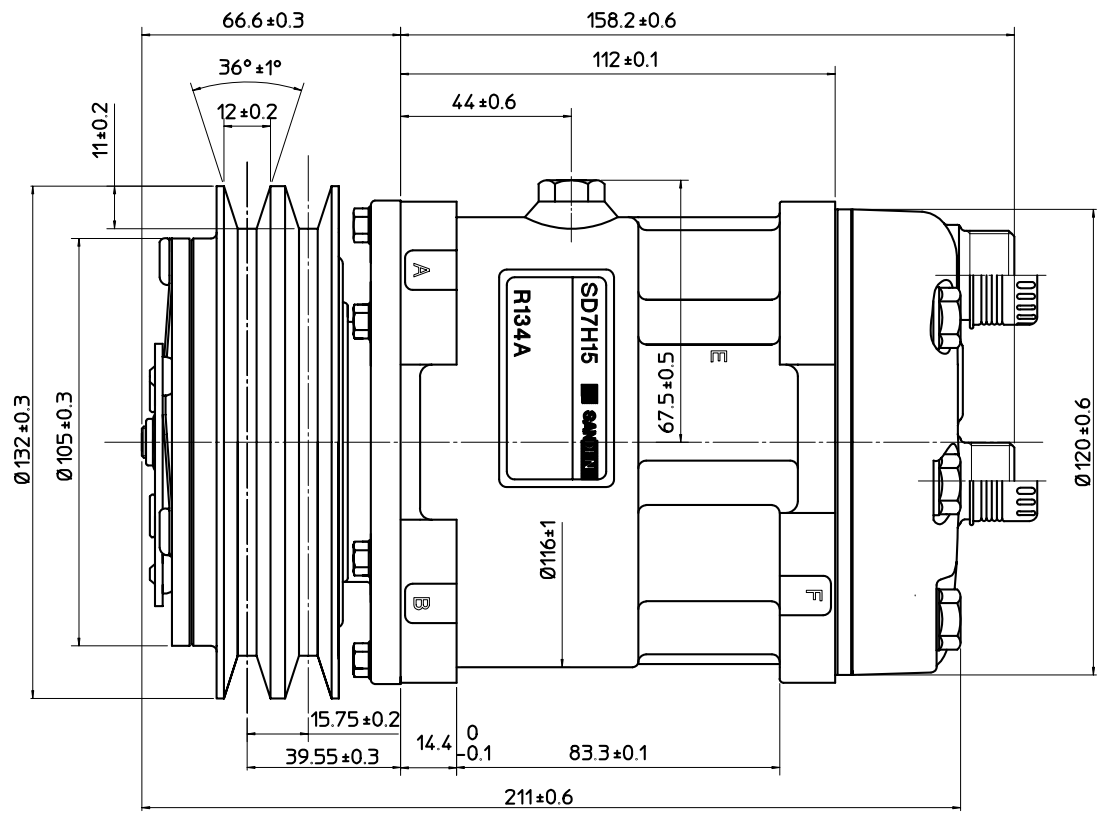

**COMPRESSOR SPECIFICATIONS**

BORE	Ø29.3 mm
STROKE	32.8 mm
DISPLACEMENT PER REVOLUTION	154.9 cc/rev
NUMBER OF CYLINDERS	7
MAXIMUM ALLOWABLE r.p.m.	7000 r.p.m.
MAXIMUM ALLOWABLE CONTINUOUS r.p.m.	6000 r.p.m.
REFRIGERANT	HFC134a
OIL(SP-10 OR EQUIV.)	135 cc
ROTATION(CLUTCH SIDE VIEW)	CLOCKWISE
WEIGHT	kg

**CLUTCH SPECIFICATIONS**

RATED VOLTAGE	DC 12 V
BREAKAWAY TORQUE	3.5 kg-m
MINIMUM ENGAGEMENT VOLTAGE	7.5 V max
POWER CONSUMPTION	43 W (Cu)
MAXIMUM ALLOWABLE r.p.m.	7000 r.p.m.
MAXIMUM ALLOWABLE CONTINUOUS r.p.m.	6000 r.p.m.
BELT TYPE	A
PULLEY DIAMETER	Ø132 mm
WEIGHT	kg



MATERIAL	PART NO.	NAME
	8227	COMPRESSOR
THIRD ANGLE PROJECTION	SCALE	MODEL
	1:1	SD7H15KG8227
DESIGN BY	CHECKED BY	APPROVED BY
20.05.2005 Raymond	20.05.2005 Masa.T.	20.05.2005 Masa.T.
REVISION RECORD		DRAWING NO.
		8227-6000S