

**SIE UNCONTROLLED COPY**  
**FOR INFORMATION ONLY**  
**INITIAL DC**  
**DATE 20/12/02**

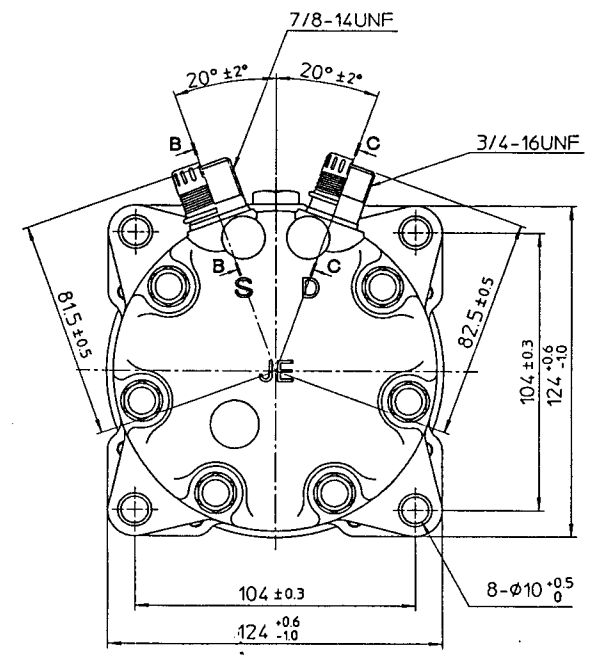
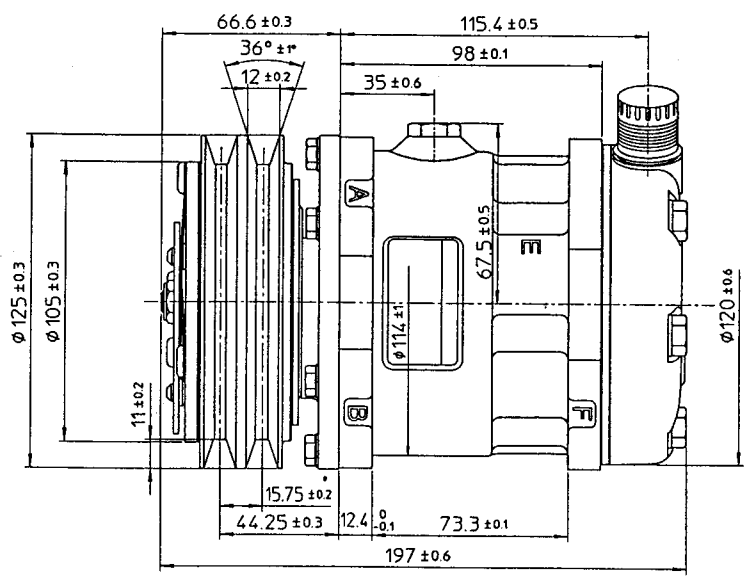
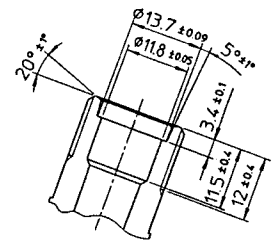
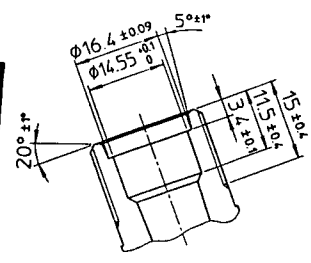
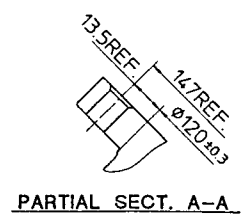
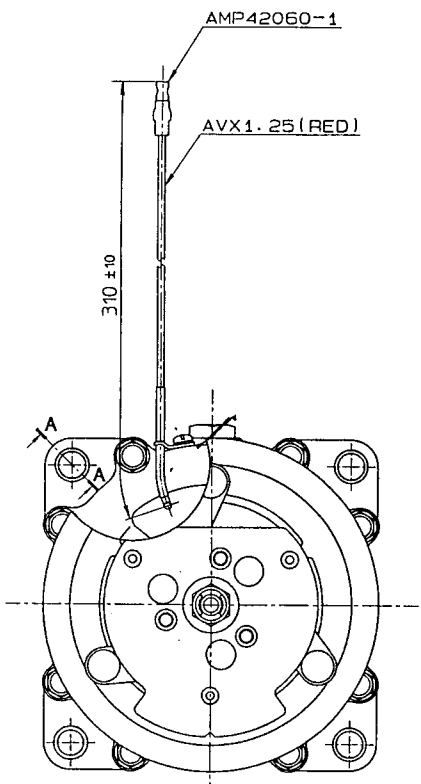

**COMPRESSOR SPECIFICATIONS**

BORE	• 29.3 mm ( 1.15 in.)
STROKE	27.4 mm ( 1.08 in.)
DISPLACEMENT PER REVOLUTION	129.2 cc/rev ( 7.9 cu.in./rev.)
NUMBER OF CYLINDERS	7
MAXIMUM ALLOWABLE r.p.m.	7000 r.p.m.
MAXIMUM ALLOWABLE CONTINUOUS r.p.m.	6000 r.p.m.
REFRIGERANT	R134a
OIL : SP-70 OR EQUIV.	135 cc ( 4.6 floz.)
WEIGHT	kg ( lb)

**CLUTCH SPECIFICATIONS**

RATED VOLTAGE	DC 12V
BREAKAWAY TORQUE	3.2 Kg-m ( 23.1 ft-lb)
MINIMUM ENGAGEMENT VOLTAGE	7.5 V MAX.
POWER CONSUMPTION	49 W (CU)
MAXIMUM ALLOWABLE r.p.m.	7000 r.p.m.
MAXIMUM ALLOWABLE CONTINUOUS r.p.m.	6000 r.p.m.
BELT TYPE	A TYPE
PULLEY DIAMETER	• 125 mm ( 4.9 in.)
WEIGHT	kg ( lb)

MATERIAL	PART NO	7312	NAME	COMPRESSOR
THIRD ANGLE PROJECTION	SCALE	1 : 1	MODEL	SD7H13JE7312
DESIGN BY	DATE	20. JUL. 1993	DRAWING NO	7312-6000
CHECKED BY	DATE	1. JUL. 1993		
REVISION RECORD	BY	DATE		